

## MS100

### General pressure transducer with piezoresistive ceramic sensors

Gauge pressure



---

#### Dimension

---

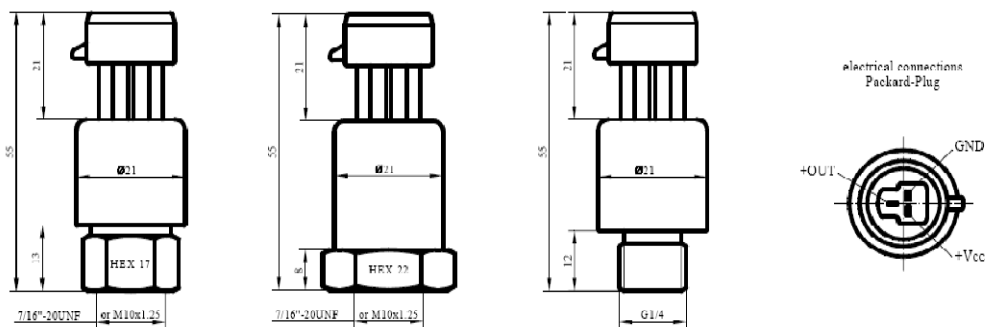

---

#### Feature

---

MS100 Series pressure transducer combine the latest Application Specific Integrated Circuit (ASIC) technology with proven piezoresistive ceramic sensors. The measuring bridge is printed directly on one side of the ceramic diaphragm by means of thick film technology. The rear part of the diaphragm can be exposed directly to the medium to be measured. Because of the excellent chemical resistance no additional protection is normally required.

MS100 transducer deliver  $\pm 0.5\%$  full scale accuracy Best Fit Straight Line (BFSL) and 2 % total error over a temperature range of  $-20\text{ }^{\circ}\text{C}$  to  $85\text{ }^{\circ}\text{C}$  [ $-4\text{ }^{\circ}\text{F}$  to  $185\text{ }^{\circ}\text{F}$ ]. Industry standard field proven connectors and process ports are offered for high reliability and user flexibility.

---

#### Typical Applications

---

- Diesel engines
- Refrigeration and HVAC/R
- General industrial
- General hydraulics
- Off road vehicles
- Braking systems
- Natural gas vehicles
- Automotive

## Specification

Measuring range:	0~350Bar
Work temperature:	-40~125°C
Overload:	1.5 times of full scales
Insulation:	≥10MΩ@50V
Accuracy (BFSL):	≤0.5% FS
Response time:	<10ms (0...99%)
Vibration / shock:	10g/5...2000HzX/Y/ZAxis/20g 11ms
Wetted parts & shell:	stainless steel or brass.
Electromagnetic compatibility:	
Electromagnetic transmit:	EN50081-1/-2
Electromagnetic sensitivity:	EN50082-2
IP rating:	IP65 or better for protection from harsh Environments
Weight:	≈45g

## Order Guide

